

KZZI机械式键盘保修条例

产品自购买之日起12个月内出现产品本身的质量问题，请按如下方式获得售后服务：

1. 购买产品7天内出现质量问题，请携带产品，购买收据以及全部附件和包装(完好无损)，前往购买处申请全额退款；
2. 购买产品15天内出现质量问题，请携带产品，购买收据以及全部附件和包装(完好无损)前往购买处申请更换新品；
3. 购买产品15天后出现质量问题，请携带产品，购买收据以及产品包装，前往购买处申请维修；
4. 个人原因造成的产品损坏，维修时须收取一定金额的费用。

拒保范畴

1. 外观损伤、无Logo或超出服务期限的产品；
2. 被拆卸、撞伤、私自升级、修理、改装或零件缺失的产品；
3. 电路烧毁或数据、电源接口损伤的产品；
4. 有异味、异象或产品夹缝内有异物的产品。



GUARANTEE
Non-human damage
12-month warranty

产品基础

PRODUCT BASIC INFORMATION



- 尺寸: 392.5(L)×144.9(W)×44.6(H)±2
Size: 392.5(L)×144.9(W)×44.6(H)±2
- 背光: RGB
Backlit: RGB
- 版本: 有线/2.4G/BT
Version: USB-C wired/2.4G wireless/BT
- 键数: 98 keys
Num of Keys: 98 keys
- 轴体: 机械轴体
Switches: Mechanical switches

指示灯

INDICATORS

1. Num
灯条指示: 充满电时, 灯条闪烁绿色五次
Light bar indication: When fully charged, the light bar flashes green five times
2. Win Lock (WIN锁指示灯做在按键上, 打开亮白光, 关闭随背光)
WIN Lock (WIN Lock indicator is made on the button, turn on the white light, turn off with the backlight)
3. Caps Lock
4. 低电量: Fn键持续闪烁红光
Low battery: Fn key continuously flashes red light
5. USB 有线模式
Wired mode
BT模式
BT Mode
2.4G模式
2.4G Mode

有线模式

WIRED MODE

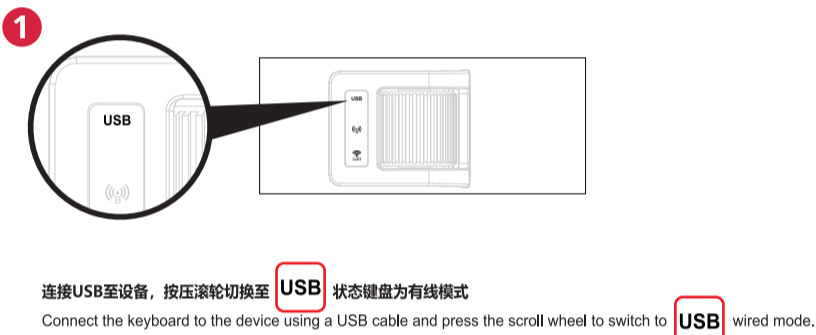

连接USB至设备, 按压滚轮切换至 **USB** 状态键盘为有线模式

Connect the keyboard to the device using a USB cable and press the scroll wheel to switch to **USB** wired mode.

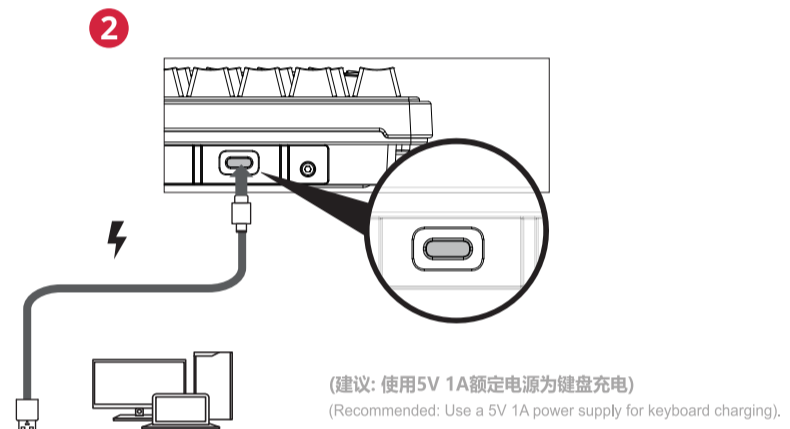

(建议: 使用5V 1A额定电源为键盘充电)
(Recommended: Use a 5V 1A power supply for keyboard charging).

BT连接

BT CONNECTION

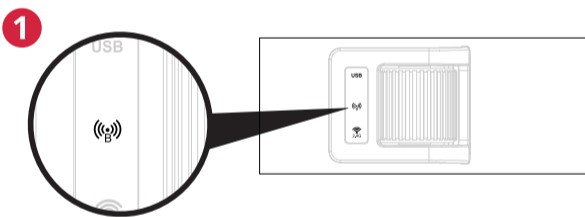

BT配对方法

BT Pairing Method

1. 长按滚轮三秒开机, 短按滚轮切换至BT状态。
Long press scroll wheel for 3 seconds to power on, short press to switch to BT mode.
2. 长按任意一组Fn+Q/W/E/3秒不动码, 比如Fn+Q, 此时Q键快速闪烁, 表示已进入配对状态, 慢闪烁表示键盘在回连状态。
To pair the keyboard, press and hold any of the key combinations of Fn+Q/W/E for 3 seconds, take Fn+Q for example, the Q key will quickly flash to indicate pairing mode, while a slow flash indicates reconnection mode.
3. 打开电脑/手机BT, 搜索并连接设备, 搜索显示的名称: KZZI-K98 (连接Windows8以上系统版本, 移动设备等)
To connect the device, open your computer or mobile device's BT settings and search for "KZZI-K98". Select it to establish the connection. Note that it is compatible with Windows 8 and above systems, as well as mobile devices.
4. 以此类推: 重复以上步骤, Fn+Q/W/E可同时存储3组BT设备, 短按Fn+Q/W/E, 即可在不同BT设备之间切换。
Similarly, Repeat the previous steps to connect and pair each desired BT device using the Fn+Q/W/E key combinations. Short press Fn+Q/W/E to switch between the stored devices.

(温馨提示: 使用切换前, 请先配对好3组BT)
(kinder reminder: Please pair the 3 BT devices before switching between them.)

2.4G连接

2.4G RECEIVER CONNECTION

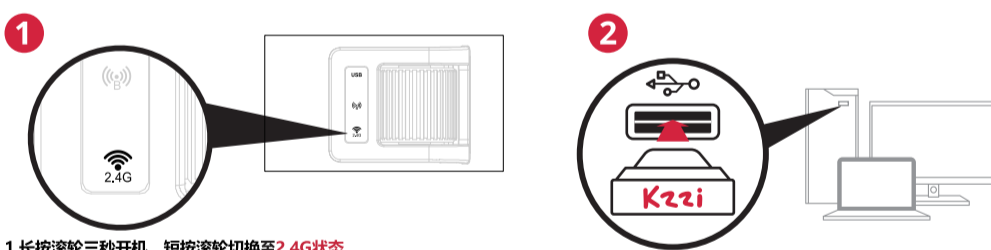

1. 长按滚轮三秒开机, 短按滚轮切换至2.4G状态
Long press scroll wheel for 3 seconds to power on, short press to switch to 2.4G mode.
2. 长按Fn+P对码, P键快速闪烁时插入接收器, P键停止闪烁即对码成功。
Long press Fn+P to pair, insert the receiver when the P key rapidly flashes, and successful pairing is indicated when the P key stops flashing.
3. P键慢闪烁表示键盘在回连状态。
Slow flashing P key indicates keyboard in reconnection mode.

(温馨提示: 出厂时2.4G接收器已配对, 无需自行再次配对; 此方法只适用于2.4G无法连接的时候使用, 设置一次即可, 无需每次都设置)
(Note: 2.4G receiver comes pre-paired. This method is only for troubleshooting 2.4G connection issues. Set it up once and no further setup is required.)

电池电量提示

KEYBOARD BATTERY LEVEL INDICATION AND CHECK

键盘背光可显示当前电池电量状态
The keyboard's lighting can display the current battery level status.



(无线模式下查看)
View in wireless mode

按Fn+ENTER 查看电池电量情况
Pressing Fn+ENTER allows you to view the battery level status. Each key from "1" to "0" represents a specific battery level range.

比如:
For example:

- 11 背光亮 表示此时键盘10%的电量
The backlight of the "1" key is illuminated, indicating that the keyboard's current battery level is at 10%.

- 11 ~ 22 背光同时亮, 表示此时键盘20%的电量
The "1" and "2" keys are both illuminated, indicating that the keyboard's current battery level is at 20%.

以此类推
Similarly

- 11 ~ 00 背光同时亮, 表示此时键盘电量 100%
When the backlighting illuminates from 1 to 0 simultaneously, it indicates that the keyboard battery is at 100% charge.

背光控制

BACKLIGHT CONTROL

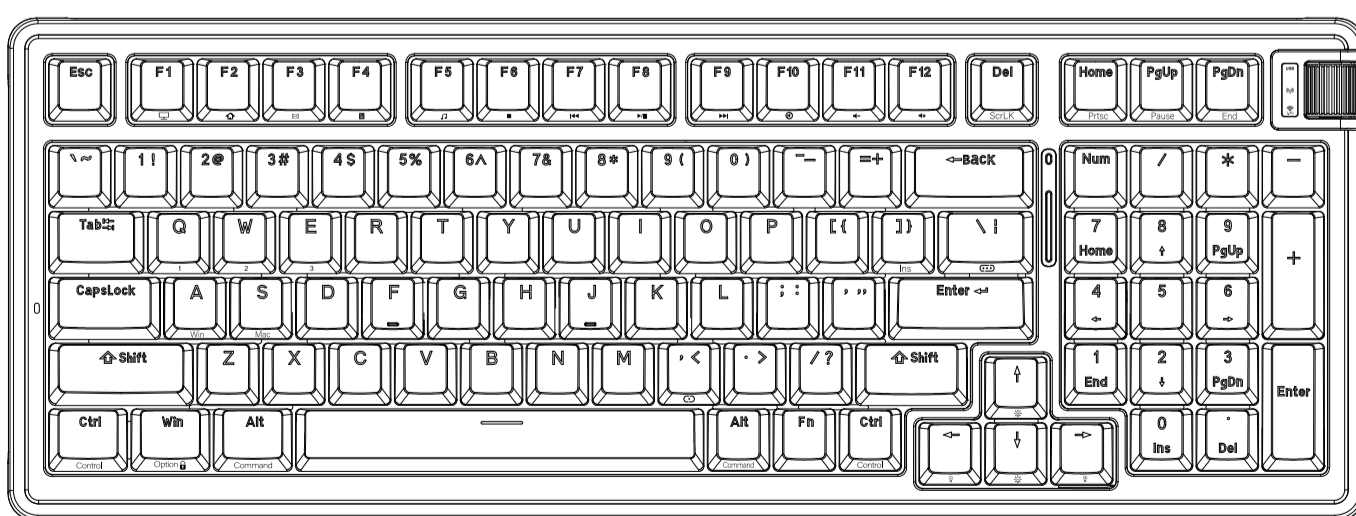

- Fn +] 支持多种背光效果切换
Multiple Backlight Effects Switch
- Fn + Del 背光亮度 +
Backlight Brightness +
- Fn + Home 背光亮度 -
Backlight Brightness -
- Fn + PgUp 窗口锁定
Window Lock
- Fn + PgDn 恢复出厂设置(长按3秒)
Restore Factory Settings(Press And Hold For 3 Seconds)
- Fn + < 背光单色切换
(仅适用于RGB版本)
Backlight Monochrome Switching
(Only Applicable to RGB Versions)
- Fn + > 背光速度 -
Backlight Speed -
- Fn + > 背光速度 +
Backlight Speed +
- Fn + < 关闭 / 打开灯光
Turn Off / On Backlight
- Fn + < 切换灯条灯效
Switch light bar lighting effect
- Fn + Num + 灯条亮度 +
Light bar brightness +
- Fn + Num - 灯条亮度 -
Light bar brightness -

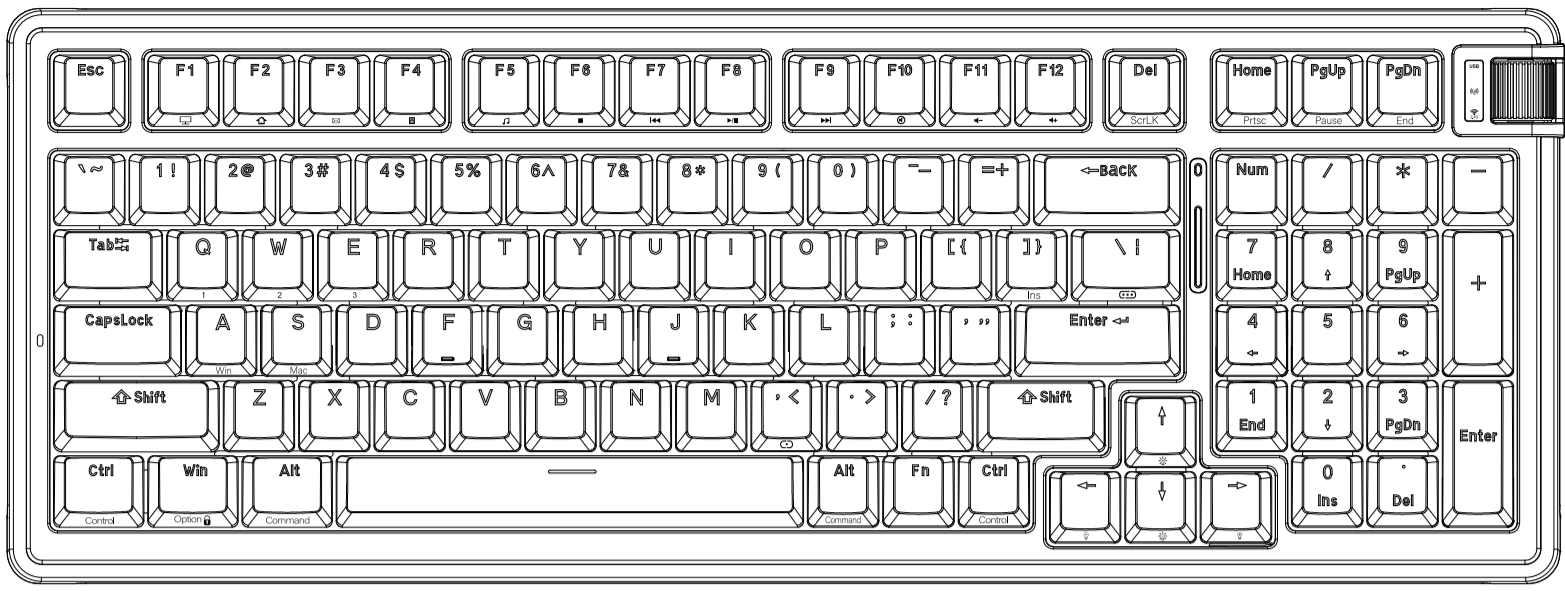

KZZI保修卡

KZZI机械键盘保修卡:

先生/女士于_____年__月__日, 在_____市_____公司

购买到型号为_____的机械键盘_____台, 在使用过程中发现产品出现_____

问题, 经_____公司检测员_____检测判定属实。

联系方式: _____

客户联系方式: _____

报修日期: _____年__月__日

服务热线: 400-829-7770

更多精彩请登陆KZZI官网: www.kzzi.com



GUARANTEE

Non-human damage
12-month warranty

背光录制

BACKLIGHT RECORDING

Step1: Press **Fn** + **!** to customize backlight

第一步: 按 **Fn** + **!**
选择一组将要自定义的背光

Step2: Press **Fn** + **BACK** Enter backlit recording mode

第二步: 按 **Fn** + **BACK** 进入背光录制模式

Fn + **2@** / **3#** 为固定灯效, 不可录制

Fn + **2@** / **3#** Fixed light effect, not recordable

第四步: 完成后, 再次按 **Fn** + **BACK**,
将保存并退出背光录制模式

Step4: When done, press **Fn** + **BACK** again,
will save and exit backlight recording mode

第三步: 按下想要录制背光的按键,
重复此步骤, 录制自己想要的背光

Step3: Press the keys which you want to record the backlight, and repeat this step

WINDOWS多媒体键

WINDOWS MULTIMEDIA KEYS

Windows系统 (FN+A: 切换到Windows系统)

In Windows mode (FN+A: Switch to Windows system)

Fn + **F1** 我的电脑
Computer

Fn + **F2** 浏览器
Browser

Fn + **F3** 邮箱
Email

Fn + **F4** 计算器
Calculator

Fn + **F5** 播放器
Media Player

Fn + **F6** 停止
Pause

Fn + **F7** 上一曲
Previous Song

Fn + **F8** 播放/暂停
Play/Pause

Fn + **F9** 下一曲
Next Song

Fn + **F10** 静音
Mute

Fn + **F11** 音量 -
Volume -

Fn + **F12** 音量 +
Volume +

MAC多媒体键

MAC MULTIMEDIA KEYS

MAC系统 (FN+S: 切换到MAC系统)

In macOS mode (FN+S: Switch to macOS system)

Fn + **F1** 屏幕亮度 -
Screen Brightness -

Fn + **F2** 屏幕亮度 +
Screen Brightness +

Fn + **F5** 键盘背光亮度 -
Keyboard Backlight Brightness -

Fn + **F6** 键盘背光亮度 +
Keyboard Backlight Brightness +

Fn + **F7** 上一曲
Previous Song

Fn + **F8** 播放/暂停
Play/Pause

Fn + **F9** 下一曲
Next Song

Fn + **F10** 静音
Mute

Fn + **F11** 音量 -
Volume -

Fn + **F12** 音量 +
Volume +

Thank you for choosing KZZI products! If you have any questions or need assistance, please feel free to contact us. Our team is dedicated to providing support and addressing your inquiries.

We highly value your feedback and suggestions as they help us continuously improve and enhance product quality. Once again, we appreciate your support for KZZI!

KZZI